



TRIANGLE
TRANSPORTATION
CHOICES

Triangle

2001



December 2025

TDM Partners Monthly Newsletter

Keeps all partners connected and informed
on what's happening across the region.



IMPORTANT DATES

Jingle & Mingle at RusBus- Dec. 11th

Learn More

SEACT Meeting- Dec. 11th

Register **Here**

Year End Regional Workshop - Dec. 16th

SEACT Proposals Submissions- Dec. 23rd

Learn More

Virtual All Partners Meeting - Jan.14th



Raise Awareness for Pedestrian Safety During Darker Evening Hours

GoTriangle promoted pedestrian safety during the seasonal time change when evenings become darker earlier. The team distributed reflective vests and bracelets to help increase visibility and remind community members to stay alert and safe.

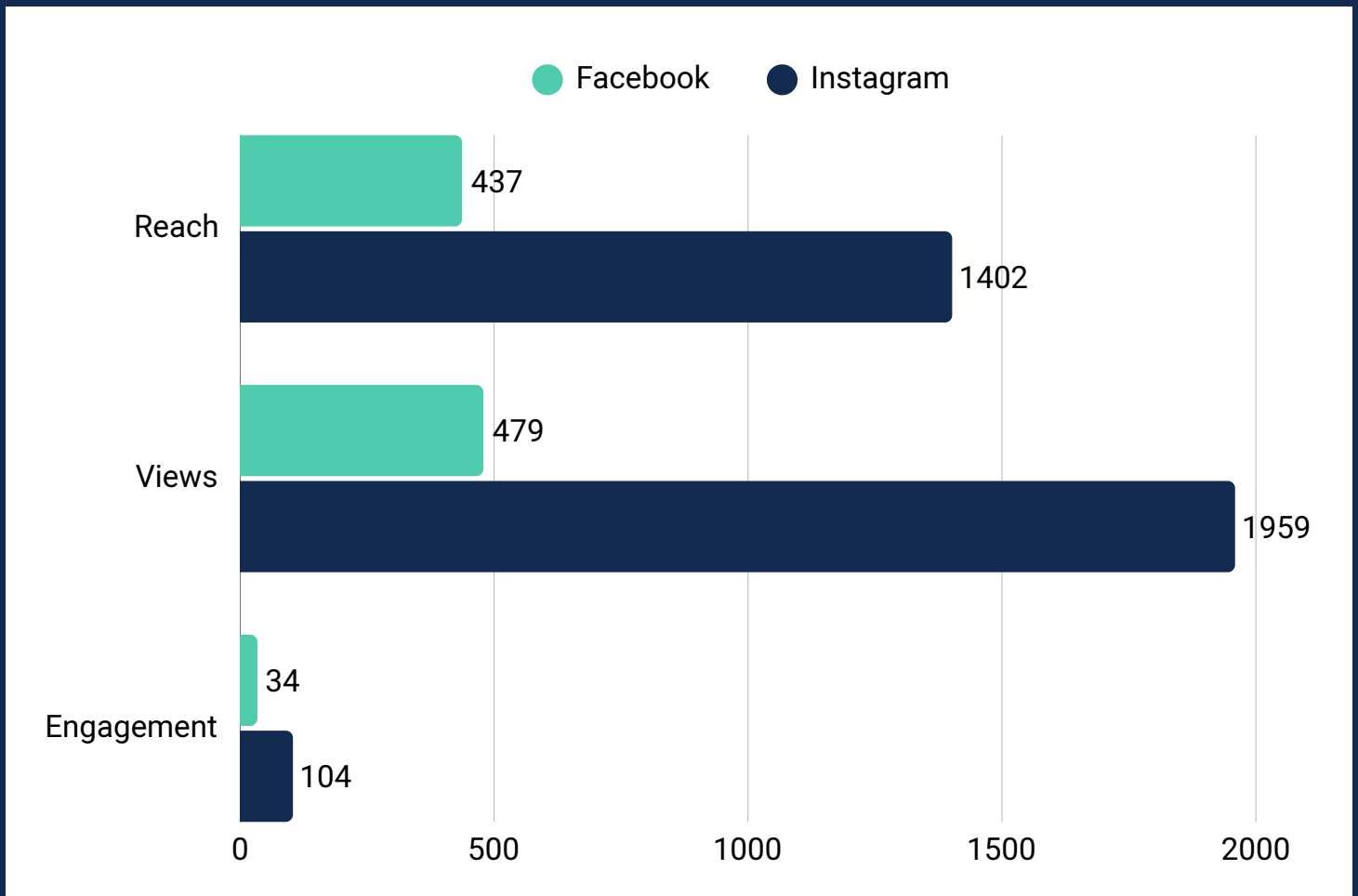

Web Page: 199 Views

[Gotriangle.org/lightenup](http://gotriangle.org/lightenup)

Earned Media:

- [Que Pasa](#)
- [Spectrum](#)
- [Hood line](#): 627,000 reach | 77 views

Videos:

- [Lighten Up](#) 754 views
- [Biking Safely After Dark Vertical](#) 1248 Views
- [Biking Safely After Dark Landscape](#) 20 Views

GoPerks Winter Partnerships: Exciting Collaborations Ahead!



This winter, GoPerks is excited to partner with The Bike Library and Fleet Feet to offer special commuter incentives that celebrate and reward sustainable travel. These collaborations are still in development, but stay tuned for more details on upcoming promo items and opportunities to get involved.

If you'd like to learn how your organization or community can use these partnerships to promote sustainable transit in your area, reach out to bmartini@gotriangle.org for more information.

ROUTE CHANGES

Going into effect March 2026



ROUTE 100

Weekday service will now operate every 15 minutes from 6am - 7pm.

There are no proposed changes to the route's alignment or stops.

ROUTE 310

Route 310 will be realigned to serve the Walmart off of Shiloh Glenn Dr. in Morrisville. It will increase access to a high-demand shopping center and remove three low-ridership stop pairs in Perimeter Park, along Carrington Mill Blvd. The route will continue to operate every 30 minutes Monday-Friday from 6am – 6:30pm and hourly until 9:30pm. The Morrisville Smart Shuttle will continue to serve all stops within Perimeter Park.

Route 310 Removed Stops Toward RTC

- Slater Rd at Carrington Mill Blvd (WB) #1218
- 3020 Carrington Mill Blvd (SciQuest) #1974
- Carrington Mill Blvd at Paramount Pkwy (NB) #1973

Route 310 Added Stops Toward RTC

- Shiloh Glenn Dr at Belstar Ave (EB) New

Route 310 Removed Stops Toward Cary

- Slater Rd at Carrington Mill Blvd (EB) #1217
- Carrington Mill Blvd (ChannelAdvisor) #1965
- Carrington Mill Blvd at Paramount Pkwy (SB) #1966

Route 310 Added Stops Toward Cary

- Shiloh Glenn Dr at Belstar Ave (WB) New

*Routes 100 and RDU shuttle will continue to serve stops #1217 Slater Rd at Carrington Mill Blvd (EB) and #1218 Slater Rd at Carrington Mill Blvd (WB)

[Learn More](#)

ROUTE CHANGES

Continued

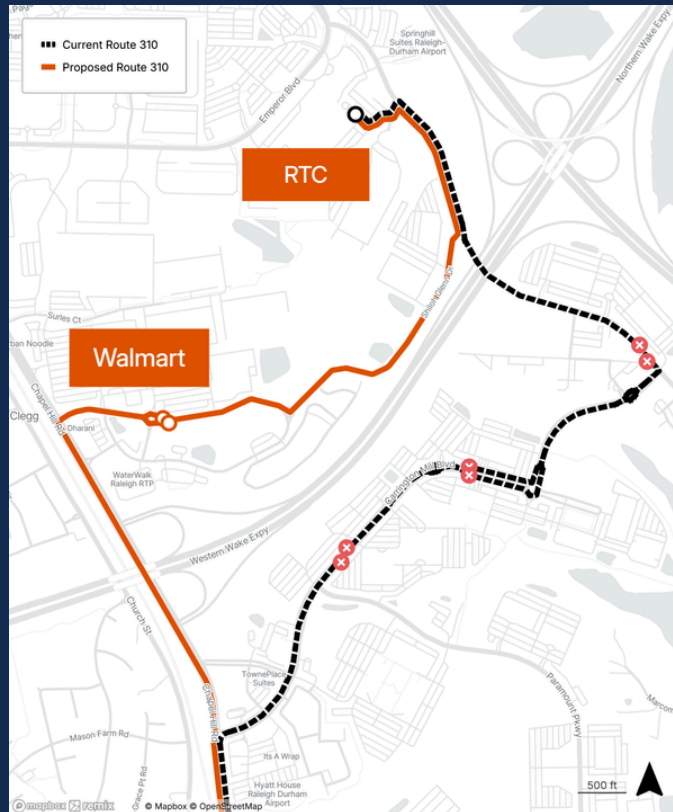

ROUTE 700 & 705

GoTriangle proposes a realignment of Route 700 in order to expand regional access to many major destinations and corridors in Southeast Durham at 30-minute service frequency, seven days a week. This route is being realigned to restore regional transit access to North Carolina Central University (NCCU) and Durham Technical Community College (Durham Tech) and add access to communities along Ellis Rd and Miami Blvd.

Weekday		Saturday		Sunday	
Time	Frequency	Time	Frequency	Time	Frequency
6am-9pm	30 minutes	6am-7pm	30 minutes	7am-6pm	30 minutes
9pm-midnight	60 minutes	7pm-midnight	60 minutes	6pm-11pm	60 minutes

[Learn More](#)

ROUTE CHANGES

Going into effect March 2026



ROUTE 700 PROPOSED STOP ADDITIONS

- New – Alston St at Lawson Rd (SB) (NCCU)
- 5532 – Alston St at Lawson Rd (NB) (NCCU)
- 6052 – Lawson St at Ridgeway Ave (EB)
- 5851 – Lawson St at Ridgeway Ave (WB)
- 6130 – Lawson St at Bacon St (EB)
- 6016 – Lawson St at Bacon St (WB)
- 5316 – Lawson St at DTCC Public Safety (EB) (Durham Tech)
- 5773 – Lawson St at Durham Tech (WB)
- New – Ellis Rd at Feeney St (EB)
- New – Ellis Rd at Feeney St (WB)
- New – Ellis Rd at New Haven Dr (EB)
- New – Ellis Rd at Brookville Ln (WB)
- 6520 – Miami Blvd at Ellis Rd (SB)
- 6263 – Miami Blvd at Ellis Rd (Bethesda Elementary) (NB)
- 6266 – Miami Blvd at New Haven Dr (SB)
- 6273 – Miami Blvd at Methodist St (NB)
- New – Miami Blvd at T.W. Alexander Dr (SB)
- New – Miami Blvd at T.W. Alexander Dr (NB)
- 6261 – Miami Blvd at Stirrup Creek Dr (PBM Graphics) (SB)
- New – Miami Blvd at Stirrup Creek Dr (NB)
- New – Miami Blvd at Patriot Dr (SB)
- New – Miami at Patriot Dr (NB)
- New – Miami at Cornwallis (SB)
- New – Miami at Cornwallis (NB)

ROUTE 700 REMOVED STOPS TOWARD RTC

- 1618 – Cornwallis Rd at Miami Blvd (EB)
- 1056 – Cornwallis Rd at West Institute Dr (SB)

ROUTE 700 REMOVED STOPS TOWARD DURHAM

- 1628 – Cornwallis Rd at Miami Blvd (WB)
- 1054 – Cornwallis Rd at West Institute Dr (NB)

[Learn More](#)

ROUTE CHANGES

Continued



ROUTE 705

Proposed Route 705 is a new route that will provide direct access to more of Research Triangle Park, including Hub RTP and Boxyard RTP. This route will provide a faster option to support transfers at Durham Station and the Regional Transit Center (RTC). It will operate every 30 minutes on weekdays from 6am-7pm. Evening trips and weekend service between Durham and the RTC will be available on a realigned Route 700.

NEW ROUTE 705 PROPOSED STOPS

- 57743 – Durham Station
- 5507 – Chapel Hill St at Gregson St (WB)
- 5934 – Duke St at Jackson St (NB)
- New – T.W. Alexander Dr at Moore Dr (WB)
- New – T.W. Alexander Dr at Moore Dr (EB)
- New – T.W. Alexander Dr at Cornwallis Rd (SB)
- New – T.W. Alexander Dr at Cornwallis Rd (NB)
- New – T.W. Alexander Dr at Research Commons Rd (SB)
- New – T.W. Alexander Dr at Research Commons Rd (NB)
- New – T.W. Alexander Dr at NC 54 (SB)
- New – NC 54 at T.W. Alexander Dr (WB)
- 1864 – NC 54 at Research Triangle High School (EB)
- 1863 – NC 54 at Park Office Dr (The Frontier)
- 1860 – NC 54 at Rodbell St (EB)
- 1861 – NC 54 at Rodbell St (WB)
- 1556 – NC 54 at New Millennium Way (EB)
- 1557 – NC 54 at New Millennium Way (WB)
- 1566 – Slater Rd at Miami Blvd (EB)
- 1558 – Slater Rd at Creekstone Dr (WB)
- 1221 – Slater Rd at Page Rd (EB)
- 1499 – Slater Rd at Page Rd (WB)
- 1222 – Slater Rd at Emperor Blvd (EB)
- 1563 – Slater Rd at Emperor Blvd (WB)
- 1776 – Slater Rd at GoTriangle (EB)
- 1777 – Slater Rd at Sheraton Hotel (WB)
- 1000 – Regional Transit Center (RTC)

[Learn More](#)

ROUTE CHANGES

Continued



*RTP Connect will continue to provide access to destinations near these stops. Riders may book a trip using RTP connect at Regional Transit Center or at Boxyard in RTP.

Visit rtpconnect.com or call 919-485-7433 for more information.

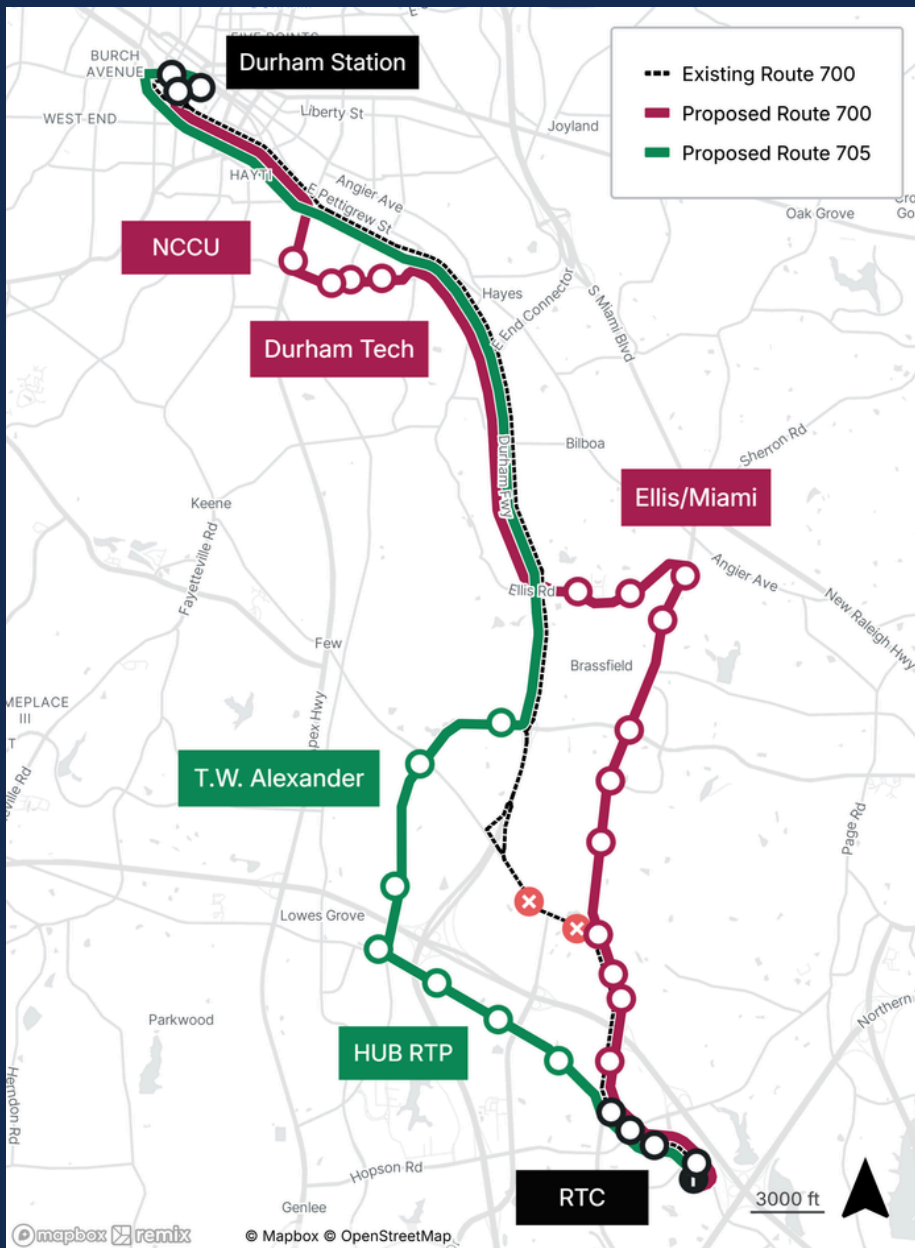

[Learn More](#)

- Our Hours
- Plan your Trip
- Our Board
- Learn about Job Openings

Explore Fare Options ▶

NEW CHAT BOT FEATURE

November Service Changes

Effective Sunday, November 9th Routes WRX and ZWX will be served by GoTriangle

bus. In addition, GoTriangle is making major timing adjustments to be more helpful of riders to improve overall service. Routes 100, 300, 400, 500, 600 and 800/801

Learn More ▶

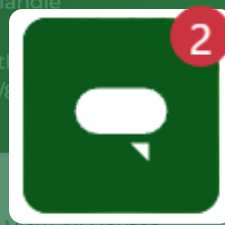

Trip Planning

View All Routes

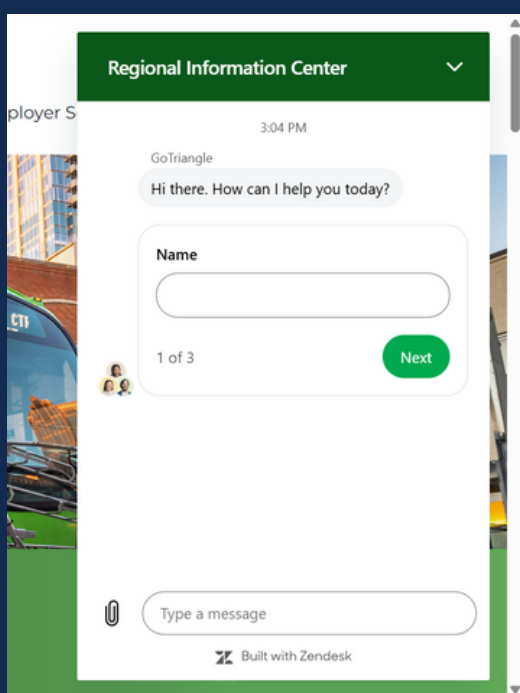

GoTriangle’s new web-based chat support feature is now live on the GoTriangle website and has also been deployed across all regional partner sites. The chat box is staffed by GoTriangle customer service representatives, providing real-time assistance to riders directly through the website.

Please feel free to share this update with your teams and direct customers to use the chat feature for quick questions about routes, schedules, and trip planning.

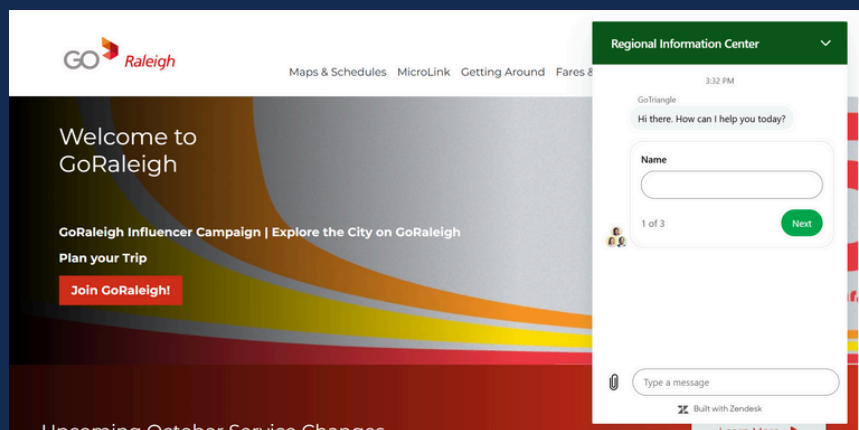
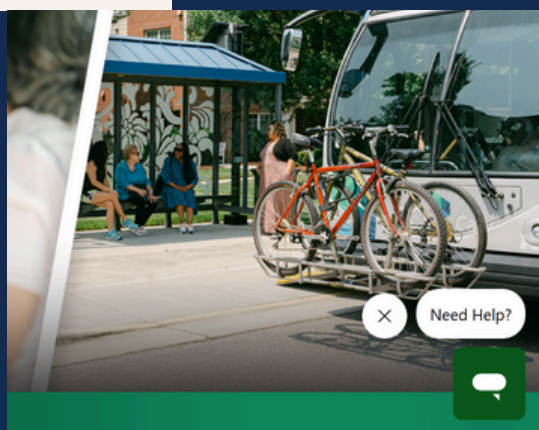



Association for Commuter Transportation

SEACT Meeting — December 2025

Join SEACT Chapter members for important updates and discussions:

Date: Thursday, December 11, 2025 Time: 10:00 AM – 11:00 AM (EST) Location: Virtual — join from anywhere!

Don't miss this opportunity to stay informed and connected with your chapter.

Register [Here](#)

Call for proposals submission date

Proposal Submissions Due: **December 23, 2025**

ACT International Conference - Pittsburgh, PA

July 26 - 29

[Learn More](#)



RESOURCES

GOTRIANGLE PRINT MATERIAL REQUEST FORM



IF YOU WOULD LIKE PRINT MATERIAL, PLEASE COMPLETE GOTRIANGLE PRINT MATERIAL REQUEST FORM

OUTREACH ASSISTANCE



IF YOU WOULD LIKE OUTREACH ASSISTANCE WITH AN EVENT IN YOUR HOTSPOT, PLEASE COMPLETE THE **TDM OUTREACH EVENT REQUEST FORM**

INDIVIDUALIZED ASSISTANCE



FEEL FREE TO PROMOTE INDIVIDUALIZED ASSISTANCE! **INDIVIDUALIZED ASSISTANCE FORM**



PLEASE SUBMIT ANY TDM RELATED EVENTS ADD TO THE TDM EVENT CALENDAR.

TDM Calendar Event Request Form
